

# Brooksby Quarry

## Southern Extension Planning Application - Update Jan 2019

This note is intended to update local residents on the progress of the southern extension planning application at Brooksby Quarry.

### Brooksby Quarry

Brooksby Quarry is an established sand and gravel quarry located between Frisby on the Wreake and Rearsby on Melton Road (A607). Phased mineral extraction and progressive restoration has taken place on the site since 2005. It is expected that the current mineral reserves will be fully extracted by early 2019.

### Southern Extension Planning Application

In July 2018, Tarmac submitted a planning application (Ref 2018/CM/0123/LCC) to Leicestershire County Council which proposed a southern extension to Brooksby Quarry that would be worked over a six year period. The existing stocking areas, silt lagoons, clean water pond, wheel cleaning facilities and offices will all be retained and the extension area will be worked in the same way as existing quarry operations.

The Environmental Assessment and public consultation has largely been completed for the application. It is hoped that the application will be presented to the planning committee in March 2019.

### Changes to the Quarry Working Scheme

Since the application was submitted, the working scheme has been revised to enable easier progression of working from the consented Phase 2 working area. The original scheme showed quarry workings progressing from west to east of the site, whereas the revised working scheme will allow Tarmac to work from east to west, as indicated below:



### Impacts of Changes

The revised scheme will not delay the previously proposed timescales for extraction and restoration, but will vary the order of completion for each working phase. However, it is still anticipated that the site will be completely restored by 2031.

The planning application will continue to include the infilling of some extraction areas with imported inert materials to restore the land to near original levels and back to agricultural use.

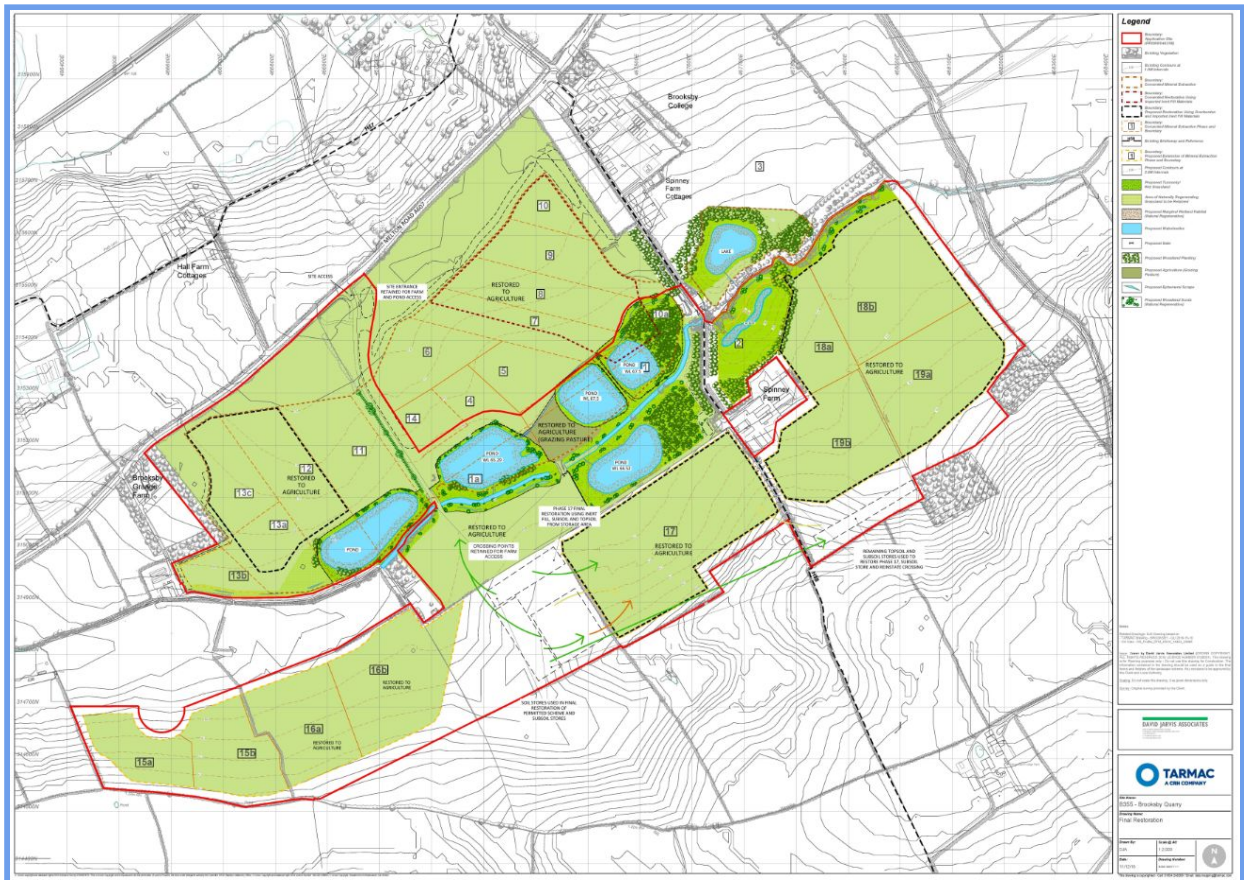

There will be no increase to the proposed traffic movements and access to the quarry will continue to be provided via Melton Road (A607).

### Contact

Please use the contact details below if you have any questions concerning the revised scheme.

[brooksby.information@tarmac.com](mailto:brooksby.information@tarmac.com)